

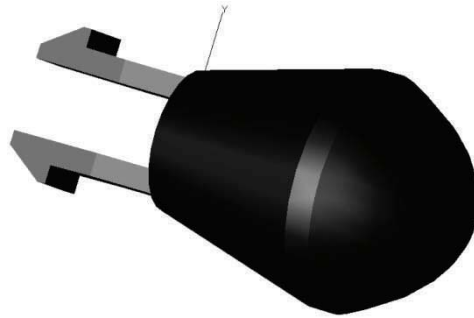

WCS100 Mold Injection Lens Design For Smart Meter Applications

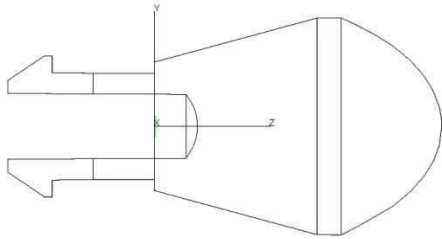

Features and Benefits

- Highly Efficient
- Easy to Maintain
- Snap On Technology
- Dual Usage (Transmitter/Receiver)
- ANSI 12-18 Optical Port Protocol
- Optimize for 10mm and 25mm targets

Description

The WCS100 is a mold injection lens designed for the smart meter application and other sensing applications is optimized for a smaller detector area, 0.635 mm in diameter. Its small size makes it easier to manufacture. Its high efficiency allows the lens to function in a dual mode, receiver and transmitter, increasing the power received by the sensor or allowing maximum power to be transmitted from an LED source. Its snap on technology allows for easy installation and removal making it easy to maintain. The lens is designed to operate over a near target (10mm) and a far target (25mm) to meet ANSI C12.18 Optical Port protocol requirements. The lens is also optimized to focus 3x the ANSI C12.18 standard energy at 10mm target distant and 2x the energy at 25mm.